

Direct Mount is included as standard.

**tailfin.**

**CargoPack Fixed System**  
Assembly Instructions

1 + 2 + 3

Steps 8 and 9 should be performed before Step 3

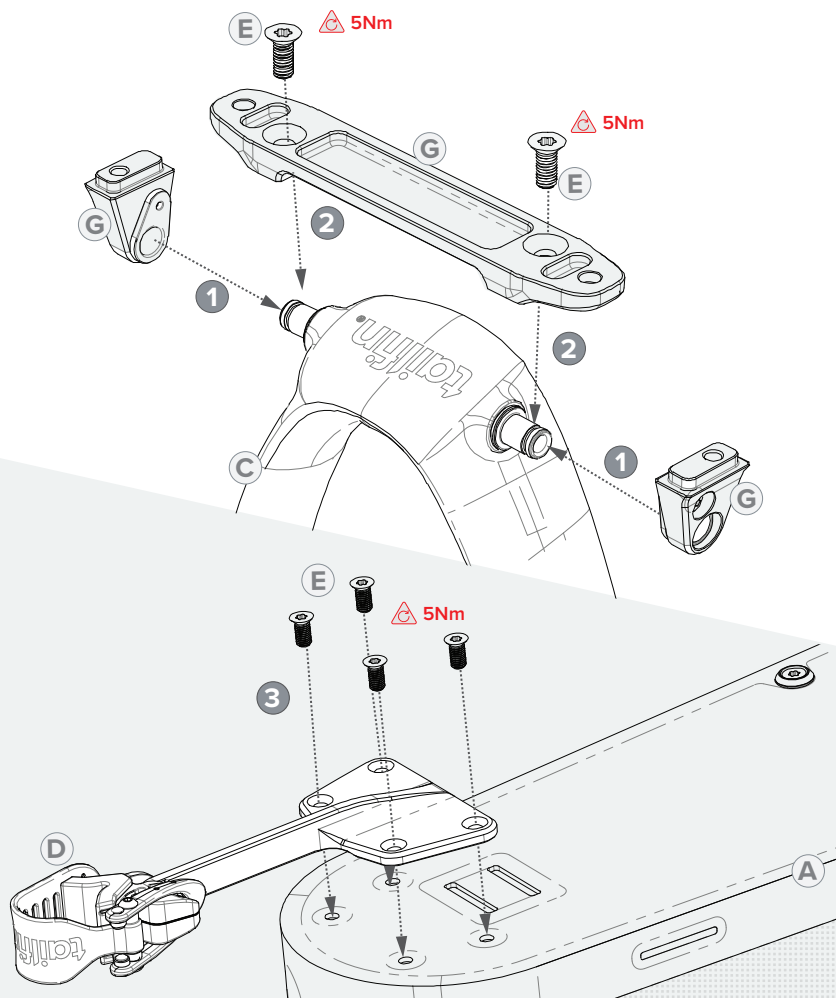

4 + ○○○

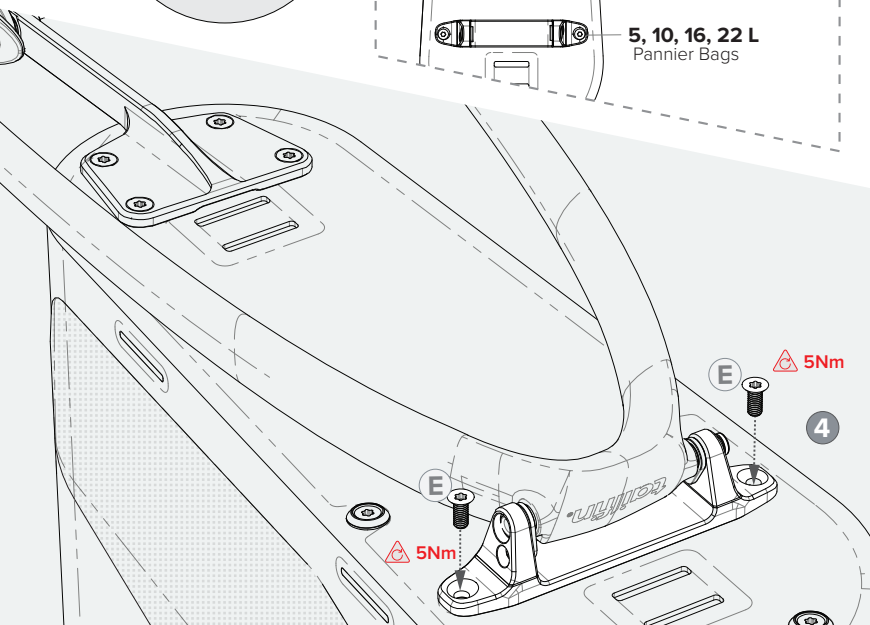
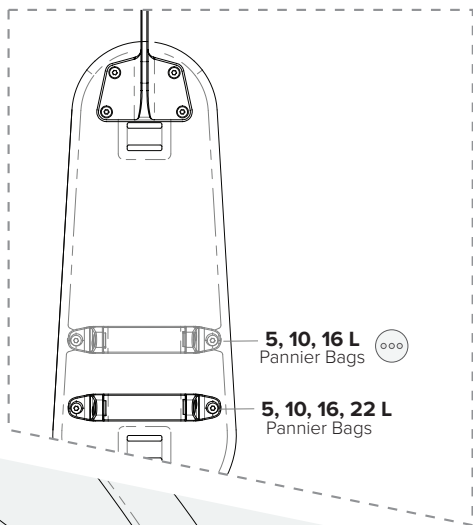
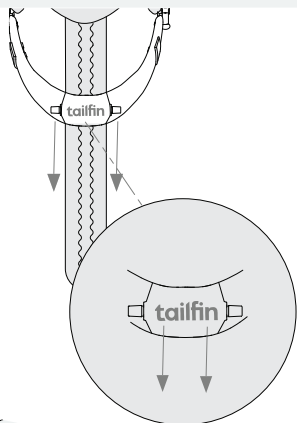

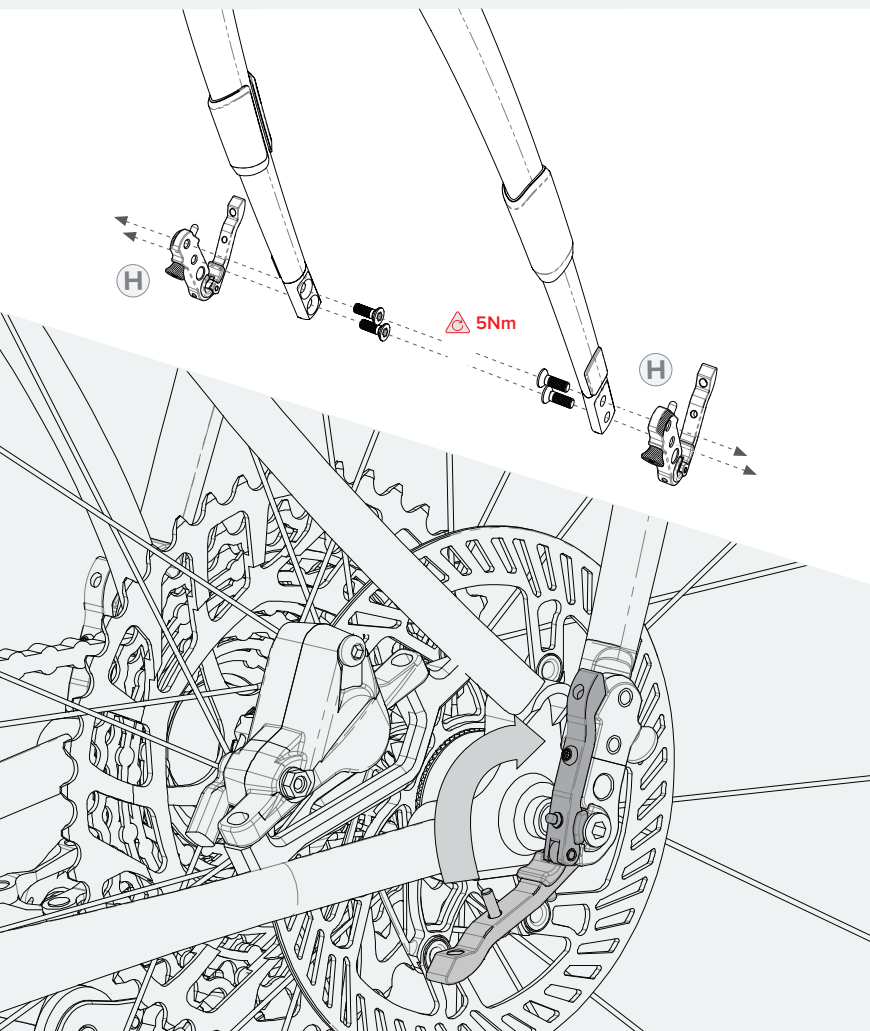



5

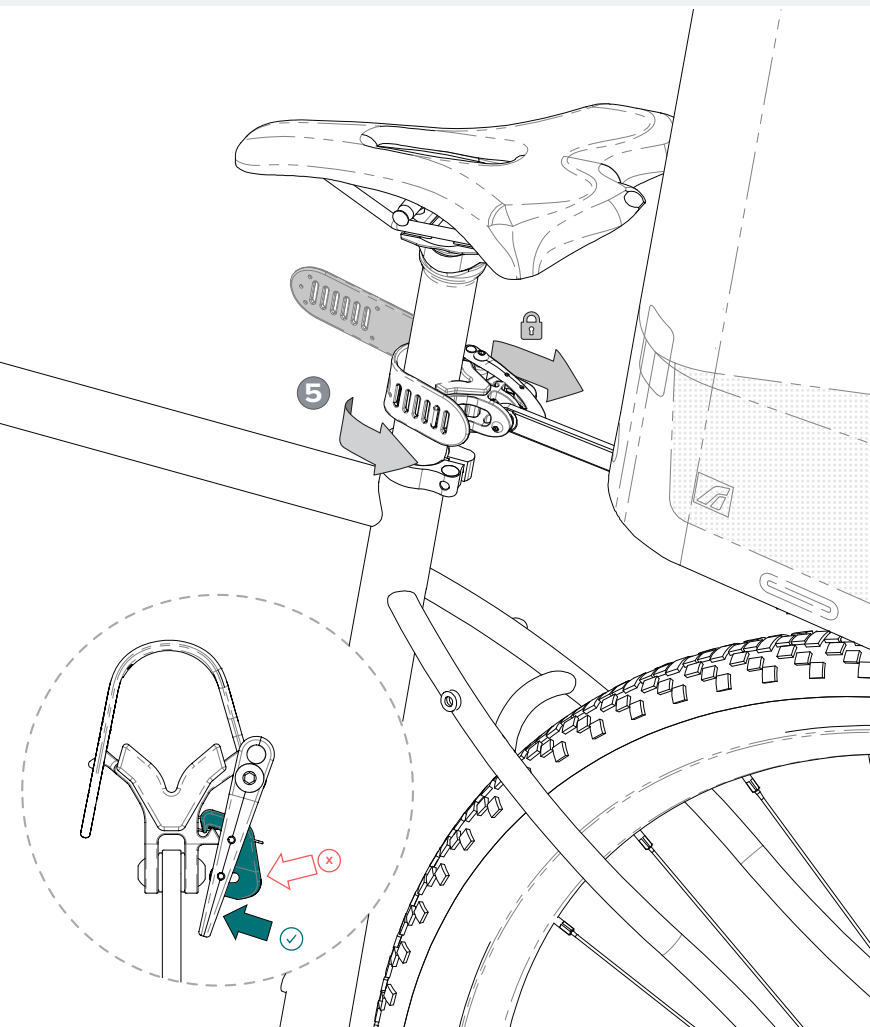

6 + 7 / 6 + 8 + 9 + 10

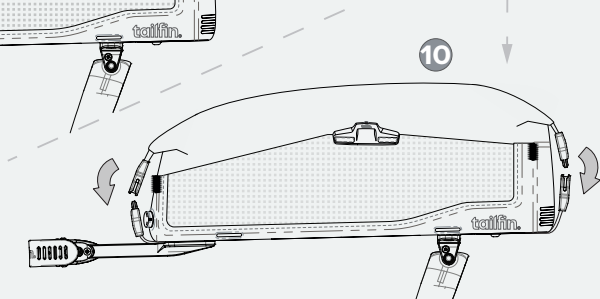
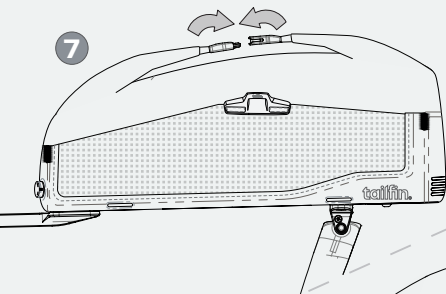
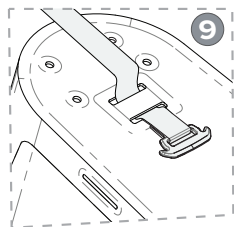
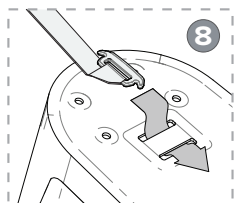
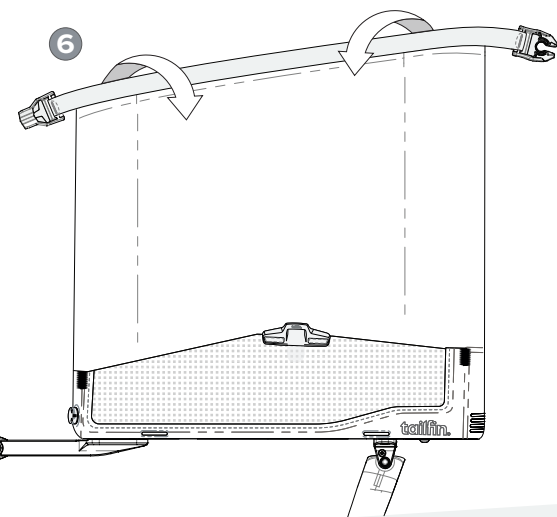

11 + 12 + ○○○

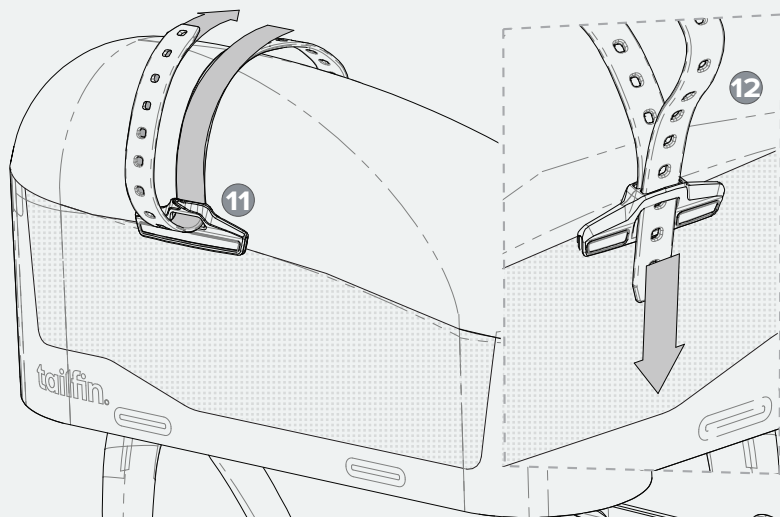
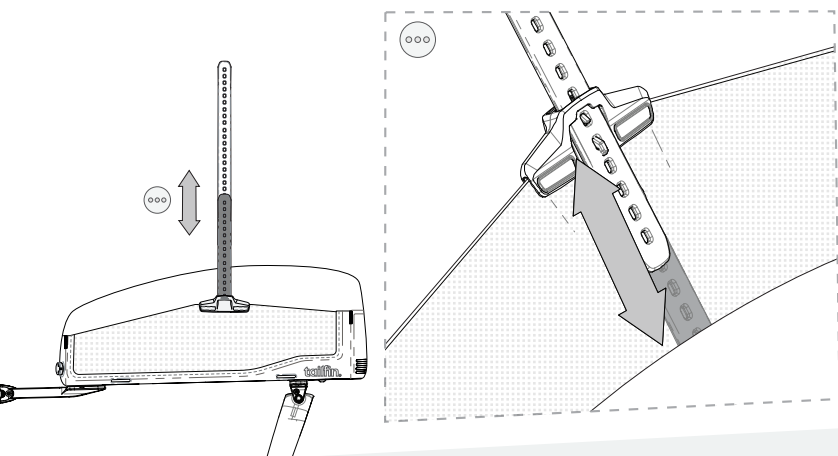



## Accessories

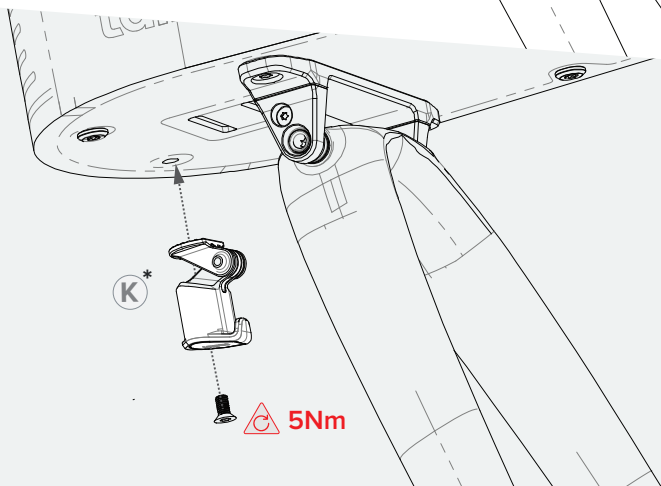
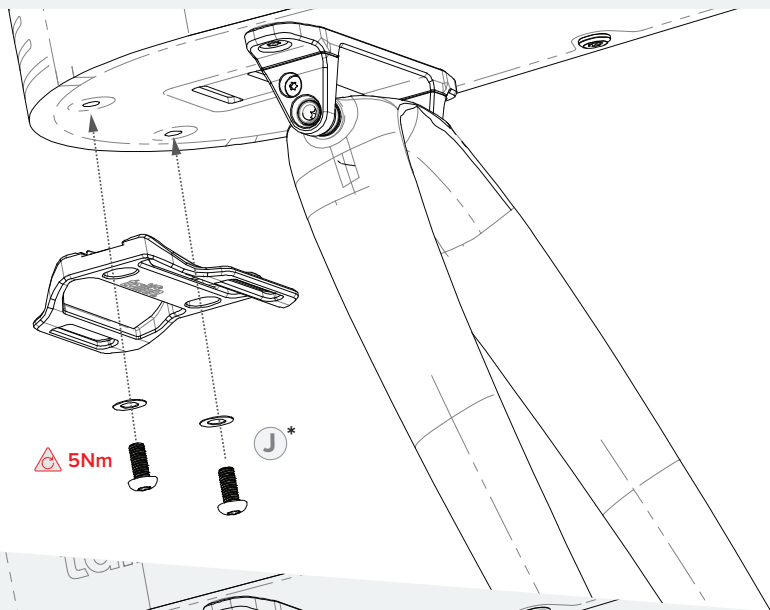



\*Included if ordered when purchasing.

- (A)** Bag
- (B)** T Hook Straps
- (C)** Arch
- (D)** Front Connector
- (E)** M5x12<sup>MM</sup> Countersunk Screw
- (F)** Long Seatpost Strap
- (G)** Arch Mount
- (I)** Fast Release Dropout Kit\*
- (H)** Thru Axle\*
- (J)** Mini Cage\*
- (K)** Seat Post Mimic\*
- (L)** Pin Connector
- (M)** Front Hook
- (ooo)** Optional Step

Product Assembly Guide

