



AeroPack

Assembly Instructions



Torx T25 Wrench
&
Torque Wrench



20 minutes

www.tailfin.cc
support@tailfin.cc
for further assistance



AeroPack

What's included

- ① AP Rack Top Bag
- ② Arch
- ③ Connector Parts
- ④ Fast Release Dropouts*
- ⑤ Axle*

①



②



③

④



⑤



* For 'Axle + Fast Release Dropout' option
If Direct Mounting [click here](#)

Orientate Arch and Fast Release Dropouts

Step One

- (A) Use the Tailfin logo to orientate the Arch.
- (B) The logo is legible when stood behind the bike. This will ensure panniers are also at the correct angle
- (C) Place Dropout on Arch. The sloped side of the dropout faces outside
- (D) The quick release pin faces backwards



(A)



(B)



(C)

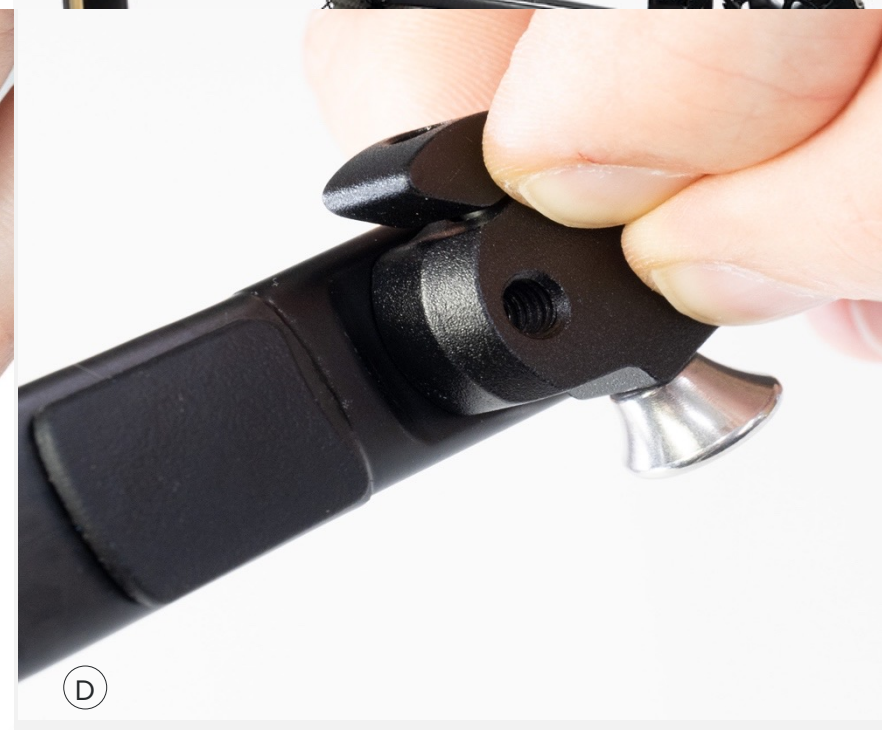

(D)

*Not applicable to Direct Mount setup, proceed to Step 3

Attach Fast Release Dropouts

Step Two

- Ⓐ Attach Dropouts to the Arch using the countersunk screws included.

Tighten screws in turn to 5Nm



Attach Connector Parts (i)

Step Three

- (A) Install first Connector piece by pushing in place
- (B) Install small Connector piece to Arch
- (C) Rotate both parts together
- (D) Screw together using shorter M5*10mm screw. Tighten to 5Nm

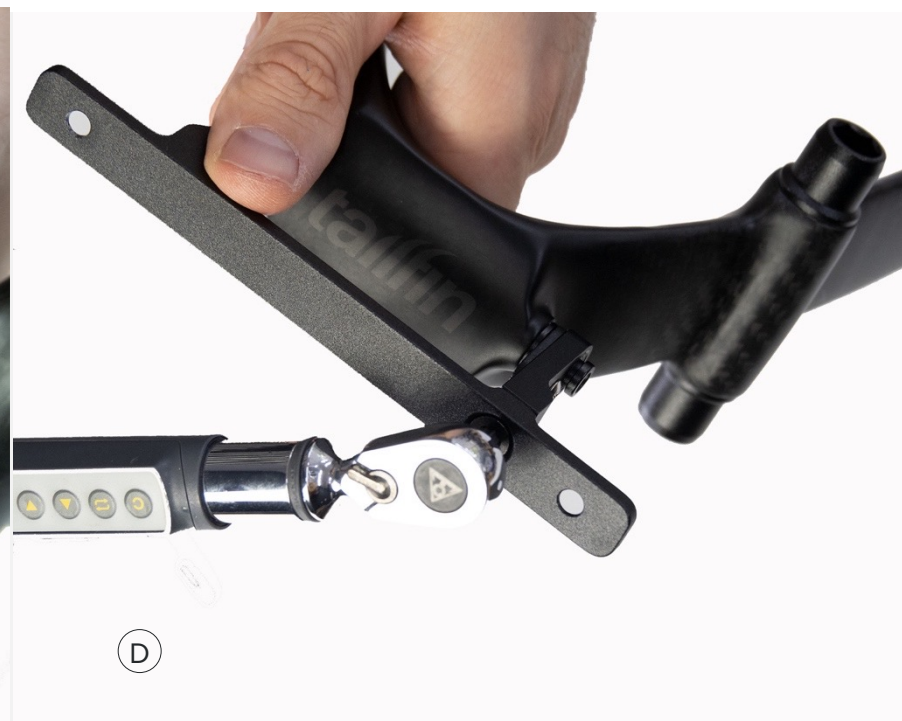

Attach Connector Parts (ii)

Step Four

- (A) Align front Connector Part. Ensure the bag strap is seated under the connector
- (B) Install part using countersunk screws. Tighten screws in turn to 5Nm



(A)



(B)

Connect Arch to Bag

Step Five

- A** Ensure Arch is correctly aligned as shown.

Using remaining countersunk screws attach the Arch to the bag

Tighten screws in turn to 5Nm
- Q** Silver pins should face up



A

Attach AeroPack to Bike

Step Six

- (A) Open Fast Release Dropouts
- (B) Clamp Dropouts in place around Axle/Frame Mount Adaptors
- (C) Close Seat Post Connector in place



Warning

Step Seven

- (A) Ensure 'teeth' of the Seat Post Connector are closed by pushing on the lever.

 Clamp is locked, ready to ride

- (B) DO NOT use the release button to attach the AeroPack

 Clamp is unlocked, do not ride



Anti-Theft Screws

Optional Step

- (A)** A Security Torx key and screws are included with each set of Fast Release Dropouts
- (B)** Install the screws to lock the Fast Release Dropouts to your axle



Bag Compression

Optional Step

- Ⓐ To compress the bag, open the Direct Access Pocket before you roll the bag shut.

This will help remove excess air and reduce the bag's size. Close the zip to finish



Stacking Straps

Optional Step

(A)

If you are travelling light, cross the two straps over into an 'X' to prevent them from moving around





AeroPack

Assembly Instructions

www.tailfin.cc
support@tailfin.cc
for further assistance