



UD/SL 22L Pannier bag
Assembly Instructions



Torx T25 Wrench
&
Torque Wrench



10 minutes

www.tailfin.cc
support@tailfin.cc
for further assistance



UD/SL 22L Pannier

What's included

- ① Pannier Bag
- ② Pannier Clamp
- ③ Lower Hook
- ④ Third Party Spacers
- ⑤ Screws/washer
- ⑥ Shoulder Strap



Align hardware for
installation

Step One

- (A) For non drive-side mounting attach clamp in top left corner with hook pointing right
- (B) For drive-side mounting attach clamp in top right corner with hook pointing left

(A)



(B)



* Tip; Lower Hook points in direction of travel

Install Mounting hardware

Step Two

- (A) Align Pannier Clamp. Use two countersunk screws and tighten to 5Nm
- (B) Align Lower Hook. Use buttonhead screw and tighten to 2 - 2.5Nm
- (C) Install spare washer and remaining screw into unused mounting point. Tighten to 2Nm
- (D) Pannier ready to attach to Rack/AeroPack



Attach Pannier to Arch

Step Three

- (A) Align clamp with pannier mounts
- (B) Close clamp lever
- (C) Ensure lower hook sits inside the arch

⚠ Hook incorrectly fitted

* Remove shrink wrap after checking fit

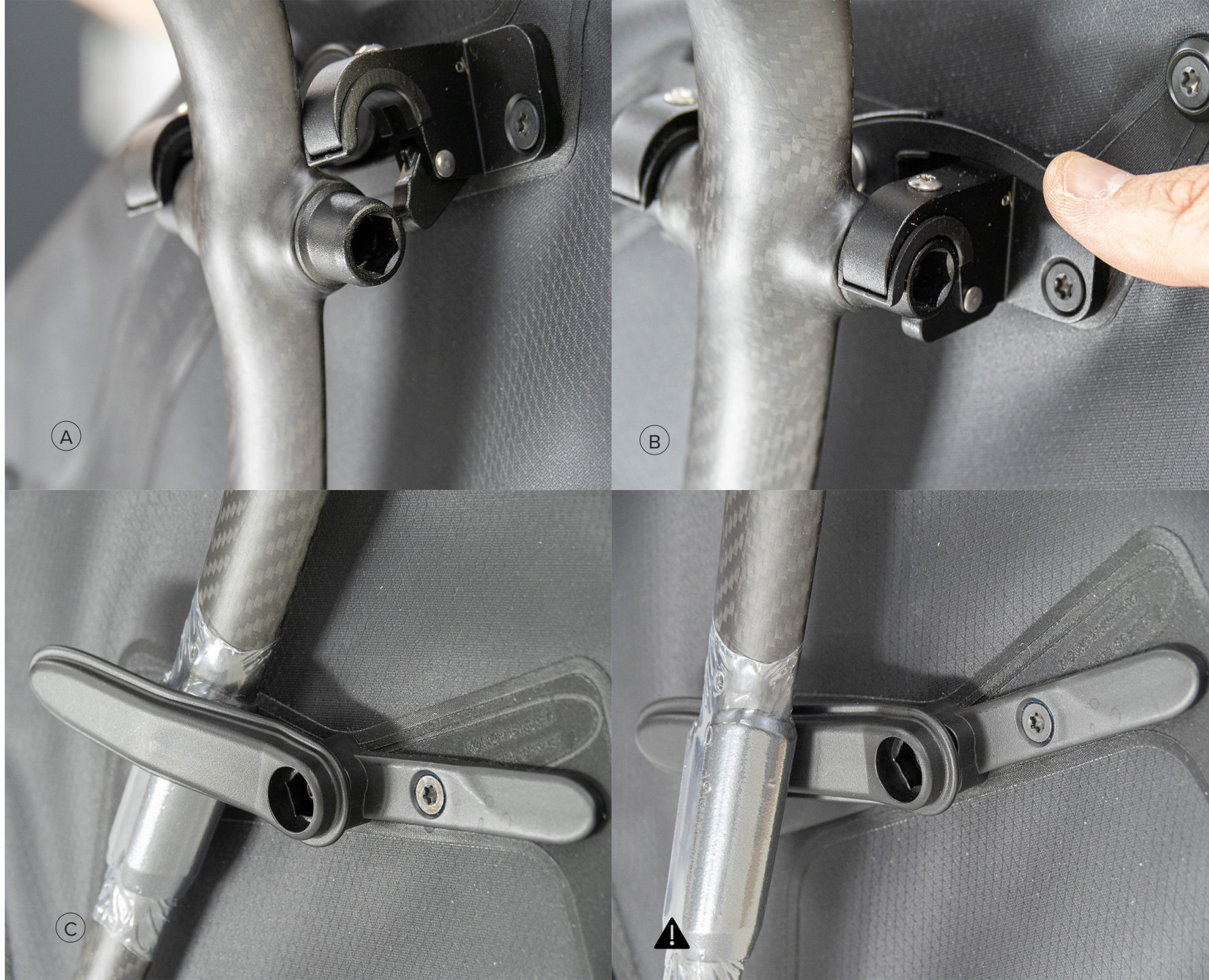

Bag Compression

Optional Step

- (A) Open integrated compression valve
- (B) Roll the bag a minimum of two times to ensure bag remains waterproof
- (C) Close side buckles
- (D) Close compression valve



(A)



(B)



(C)



(D)

Shoulder strap

Optional Step

(A)

Attach Shoulder Strap to
side-release buckles





UD/SL 22L Pannier bag

Assembly Instructions

www.tailfin.cc
support@tailfin.cc
for further assistance